

**Village of Grand Ridge**  
**Application for Permit to Erect Fencing**

Permit # \_\_\_\_\_

Fee \_\_\_\_\_

Name: \_\_\_\_\_ Phone: \_\_\_\_\_

Address: \_\_\_\_\_

Type of fence:  Board Panel  Picket  Split Rail  Wrought Iron  Chain Link  
 Masonry  Other Composite Material (attach product literature). Height \_\_\_\_\_

**It is the responsibility of the applicant to contact utilities prior to digging fence posts.**

**Contact J.U.L.I.E. 1-800-892-0123**

**ON THE BACK OF THIS PERMIT DRAW PROPOSED FENCE & LOT LINES.**

Contractor: \_\_\_\_\_

Contractor Lic. # \_\_\_\_\_

It is strongly advised that the property owner obtain a current survey and locate the property stakes to insure correct location of the fence, inside the property. **If the fence is erected on Village property it will have to be removed. It is the responsibility of the owner to insure the fence is within the property lines.**

**Location and Height Requirements**

1. No fence, wall or other obstruction shall be permitted in the public right of way
2. No fence shall exceed four feet (4') in height within the front yard or side yard adjacent to the street. Chain link fences shall not be permitted along street frontage or within front yards.
3. No fence shall exceed six feet (6') in height.
4. No fences in the front yard area or side yard adjacent to the street shall be erected or constructed as to obstruct visibility through more than fifty (50) percent of the fence surface when viewed from a perpendicular angle.
5. Fences erected on corner lots shall not interfere with the clear vision of pedestrians and motorists as determined by the Village Engineer.
6. All fences shall be located within the lot's property lines.
7. No fence shall be located closer than twelve (12") inches to a public sidewalk.
8. No gate or fence shall be erected, constructed or installed across a driveway within the front yard of a residential lot.

**Construction Requirements**

1. All fences of other than masonry construction shall be securely anchored below the ground level at depths equal to or exceeding forty (40) percent of the above ground height and shall conform to all applicable building codes as adopted by the Village Council.
2. The unfinished side of any fence, including exposed posts, framing and cross members shall face the interior of the lot.
3. No fence shall be erected except those of board panel, picket, split rail, wrought iron, chain link, masonry construction, composite materials designed for fencing or decorative fence material approved by the Building Official.
4. All chain link fences shall be constructed, erected and installed so that the twists (barbed ends) are toward the ground. Barbed wire and electrically charged fences are not permitted.

5. No board panel fence constructed of boards greater than one and one-quarter (1.25") inch in thickness or twelve (12") inch width shall be erected.
6. No fence shall be erected, constructed or installed on posts greater than eight (8") inches width or diameter.
7. Both sides of all fences shall be maintained in good repair, and any fence determined by the building inspector to be unsafe and a hazard to the public safety or unsightly due to its disrepair, shall be deemed a violation of this Permit.

This permit is valid for 180 days from the date of approval.

This permit is approved per drawings and specifications. Any changes to specifications herein must be approved in writing prior to construction.

Date: \_\_\_\_\_ By: \_\_\_\_\_  
Building Official, Village of Grand Ridge

I the undersigned, certify that if a permit is issued to me, I will comply with all provisions of building, electric, plumbing, and other applicable ordinances of the Village of Grand Ridge and shall perform all work, or cause all work to be performed according to the provisions of said ordinances. I, or my agent, shall personally supervise the work and shall do or cause to have done said work according to plans, specifications and other written information supplied as part of this application. I am familiar with the applicable ordinances and the provisions thereof and in signing this application do willingly become responsible for all work accomplished under the permit by all contractors, trades people, workers and shall call for inspections required at a minimum of 24 (twenty- four) hours before they become due.

Printed Name: \_\_\_\_\_

Signature \_\_\_\_\_ Date: \_\_\_\_\_

**Please contact John Hettel at 815-228-0277 for further information once you have completed the application.**

YOU MAY SUBSTITUTE A SITE PLAN OR SEPARATE DRAWING SHOWING THE INFORMATION REQUIRED ON THIS SHEET. THE SITE PLAN OR DRAWING MUST BE DRAWN TO SCALE

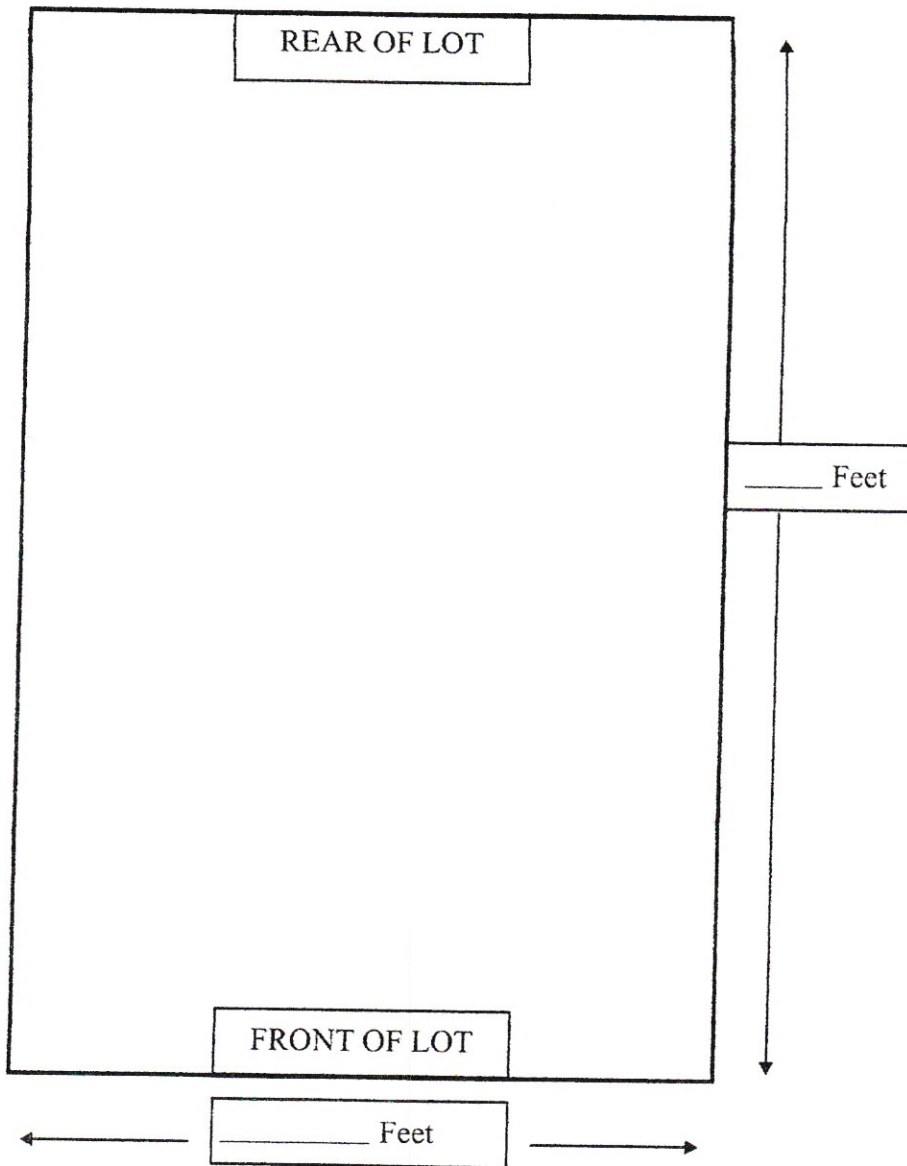

**INSTRUCTIONS:**

1. Show property lines and dimensions.
2. Show type of property adjacent to your lot, including names of streets, and location of any alleys
3. Locate the fence within your property. Show distances from the fence to your property line.
4. Show the location of your house in relationship to your lot. Include distances from your house to each lot line.
5. Type of property:  
 Residential  
 Commercial/Industrial

Adjust the "North Arrow" to conform to your property.

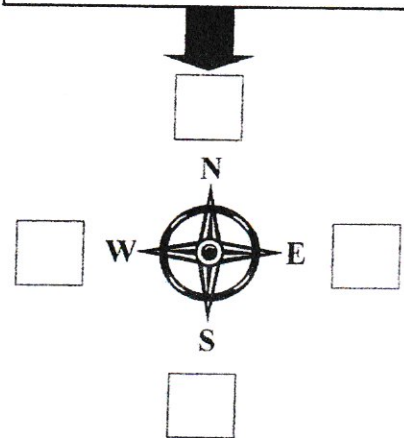

**IMPORTANT:** Property lines must be proven by one of two means:  
1. the submission of a survey conducted by a surveyor licensed by the State of Illinois (the survey will be considered valid provided that no additions or deletions have been made to the property since the date of the survey);  
or 2. the sighting by a Village Inspector of true property line monuments or stakes placed by a licensed surveyor.